

THE INFORMATION ON THIS DRAWING IS THE PROPERTY OF CELESTRA, IS DISCLOSED IN CONFIDENCE AND NOT TO BE REPRODUCED, USED OR DISCLOSED EXCEPT FOR WHICH FURNISHED.

| CELESTRA CAT.NO | WIRE SIZE | | BOLT SIZE | A ±0.06 | B MIN | C ±0.04 | R | ID ±0.01 |
|--------------------|-----------|--|--------------|------------|----------|------------|------|-------------|
| | CODE | FLEX | | | | | | |
| DA0410-251 | 4 AWG | 40-50 Navy 133/.0177 49/.029 91/24 = 36.7 kcmil | #10 | 1.32 | 0.54 | 0.55 | 0.78 | 0.28 |

- NOTE:
1. ALL DIMENSIONS ARE IN INCHES UNLESS OTHERWISE SPECIFIED.
 2. ALL DA,DB,LA,LB,WP AND J SERIES OF CAT.NO.S ARE LISTED BY "UNDERWRITERS INC." AND "CSA" FOR USE ON CODE WIRES AND FLEX/24 STRANDED CABLES.

PRE-FIX CAT.NO.WITH "L" HAS NOT PEEP HOLE UNLESS OTHERWISE SPECIFIED IN THE SUFFIX OF THE CAT.NO. WITH "P".

MATERIAL: HIGH CONDUCTIVITY WROUGHT COPPER

FINISH: ELECTOR-TIN PLATE UNLESS OTHERWISE SPECIFIED PLATE PER MIL - T -16366.
SUFFIX CAT.NO.WITH "SP" FOR SILVER.

INSTALLATION GUIDE
DIE CODE = 29
DIE COLOR = Gray

Color coded marking

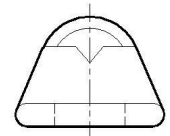
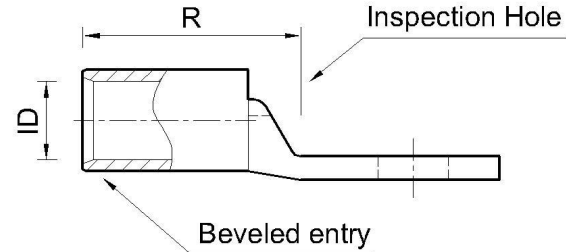
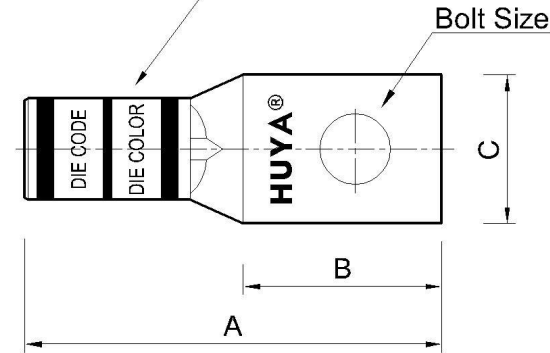

HUYA®
www.huyaco.com

CELESTRA CORPORATION
76. Huancun Rd. Zhongcun Town.
Panyu Dist. Guangzhou 511495.

TITLE WIRE CONNECTORS AND SOLDERING
LUGS FOR CODE AND FLEX CABLE

MATERIAL HIGH-CONDUCTIVITY
WROUGHT COPPER
FINISH ELECTRO TIN PLATE

PRT. NO. DA0410-251
DWG. NO. 186-cp0147

SCALE NTS
UNIT INCH

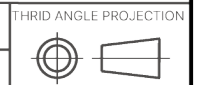

| | | | | | |
|-----|-----------|-----------|-----------|-------------------------------------|-----|
| 00 | 04-May-25 | Ruby Feng | Sinia Qiu | Celestra Standards Spec. Initialed. | ECN |
| REV | DATE | DWN | CHK | DESCRIPTION | ECN |