

4

3

2

1

THE INFORMATION ON THIS DRAWING IS THE PROPERTY OF CELESTRA, IS DISCLOSED IN CONFIDENCE AND NOT TO BE REPRODUCED, USED OR DISCLOSED EXCEPT FOR WHICH FURNISHED.

| CELESTRA CAT.NO | WIRE SIZE | | BOLT SIZE | B MIN | C ±0.04 | D ±0.015 | G ±0.02 | H ±0.01 |
|--------------------|-----------|--|--------------|----------|------------|-------------|------------|------------|
| | CODE | FLEX | | | | | | |
| DB401243A | 4/0 AWG | 200 Navy 3/0 Weld 450/24 = 182 kcmil 703/.0154 | 1/2 | 3.00 | 1.03 | 0.14 | 1.75 | 0.63 |

NOTE:

1. ALL DIMENSIONS ARE IN INCHES UNLESS OTHERWISE SPECIFIED.
2. ALL DA,DB,LA,LB,WP AND J SERIES OF CAT.NO.S ARE LISTED BY "UNDERWRITERS INC." AND "CSA" FOR USE ON CODE WIRES AND FLEX/24 STRANDED CABLES.

PRE-FIX CAT.NO.WITH "L" HAS NOT PEEP HOLE UNLESS OTHERWISE SPECIFIED IN THE SUFFIX OF THE CAT.NO. WITH "P".

MATERIAL:

HIGH CONDUCTIVITY WROUGHT COPPER

FINISH:

ELECTOR-TIN PLATE UNLESS OTHERWISE SPECIFIED PLATE PER MIL - T -16366.
SUFFIX CAT.NO.WITH "SP" FOR SILVER.

INSTALLATION GUIDE

DIE CODE = 54

DIE COLOR = Purple

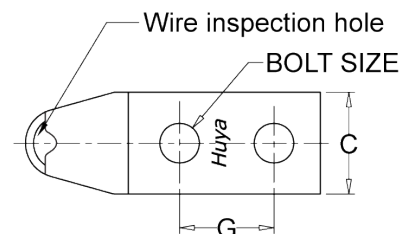
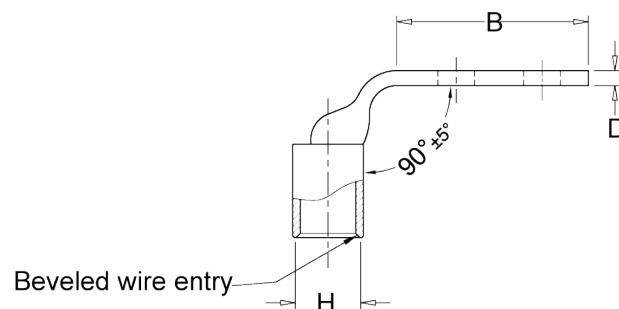

Color coded barrel markings

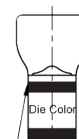

A

A

| | | | | | | | | | |
|-----|-----------|-----------|-----------|-------------------------------------|-----|--|---------------------|-----------|---|
| | | | | | | <div><div><div>HUYA®</div><div>www.huyaco.com</div></div><div><div>CELESTRA CORPORATION</div><div>76. Huancun Rd. Zhongcun Town. Panyu Dist. Guangzhou 511495.</div></div></div> | | | |
| | | | | | | TITLE WIRE CONNECTORS AND SOLDERING LUGS FOR CODE AND FLEX CABLE | | | |
| 00 | 23-Aug-25 | Ruby Feng | Sinia Qiu | Celestra Standards Spec. Initialed. | | MATERIAL HIGH-CONDUCTIVITY WROUGHT COPPER | PRT. NO. DB401243A | SCALE NTS | <div>THRID ANGLE PROJECTION</div> <div></div> |
| REV | DATE | DWN | CHK | DESCRIPTION | ECN | FINISH ELECTRO TIN PLATE | DWG. NO. 186-cp4723 | UNIT INCH | |

4

3

2

1