

4

3

2

1

THE INFORMATION ON THIS DRAWING IS THE PROPERTY OF CELESTRA, IS DISCLOSED IN CONFIDENCE AND NOT TO BE REPRODUCED, USED OR DISCLOSED EXCEPT FOR WHICH FURNISHED.

| CELESTRA CAT.NO | WIRE SIZE | BOLT SIZE | A ±0.06 | B MIN | C ±0.04 | D ±0.015 | F ±0.01 | ID ±0.01 | H ±0.04 |
|--------------------|-----------|-----------|------------|----------|------------|-------------|------------|-------------|------------|
| | Code | | | | | | | | |
| AL0114-62 | #1 AWG | 1/4 | 1.98 | 0.75 | 0.75 | 0.17 | 0.33 | 0.37 | 0.91 |

NOTE:

1. ALL DIMENSIONS ARE IN INCHES UNLESS OTHERWISE SPECIFIED.
2. ALL DA,DB,LA,LB,WP,AL,AS AND J SERIES OF CAT.NO.S ARE LISTED BY "UNDERWRITERS INC." AND "CSA" FOR USE ON CODE WIRES AND FLEX/24 STRANDED CABLES.

PRE-FIX CAT.NO.WITH "L" HAS NOT PEEP HOLE UNLESS OTHERWISE SPECIFIED IN THE SUFFIX OF THE CAT.NO. WITH "P".

MATERIAL:

ALUMINIUM ALLOY

FINISH:

ELECTOR-TIN PLATE UNLESS OTHERWISE SPECIFIED PER MIL - T - 16366.
SUFFIX CAT.NO.WITH "SP" FOR SILVER.

INSTALLATION GUIDE

DIE CODE = 45
DIE COLOR = Gold

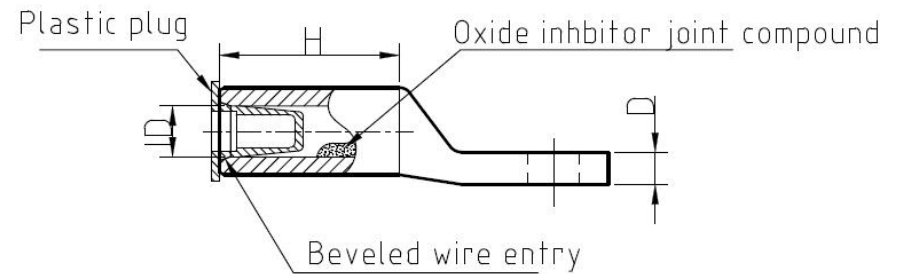

HUYA[®]
www.huyaco.com

CELESTRA CORPORATION

76. Huancun Rd. Zhongcun Town.
Panyu Dist. Guangzhou 511495.

TITLE WIRE CONNECTORS AND SOLDERING
LUGS FOR CODE AND FLEX CABLE

MATERIAL ALUMINIUM ALLOY

PRT. NO. AL0114-62

SCALE NTS

THIRD ANGLE PROJECTION

FINISH ELECTRO TIN PLATE

DWG. NO. 186-cp5068

UNIT INCH

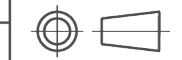

| | | | | | |
|-----|-----------|-----------|-----------|-------------------------------------|-----|
| 00 | 09-Apr-26 | Ruby Feng | Sinia Qiu | Celestra Standards Spec. Initialed. | |
| REV | DATE | DWN | CHK | DESCRIPTION | ECN |

4

3

2

1