

4

3

2

1

THE INFORMATION ON THIS DRAWING IS THE PROPERTY OF CELESTRA, IS DISCLOSED IN CONFIDENCE AND NOT TO BE REPRODUCED, USED OR DISCLOSED EXCEPT FOR WHICH FURNISHED.

| CELESTRA CAT.NO | WIRE SIZE | BOLT SIZE | Dimension (in) | | | | | | | |
|--------------------|-----------|-----------|----------------|------|------|------|------|------|------|------|
| | | | A | B | C | D | F | ID | OD | H |
| J06AN0614 | 6AWG | 1/4 | 1.30 | 0.52 | 0.49 | 0.07 | 0.24 | 0.22 | 0.30 | 0.58 |

- NOTE:
1. ALL DIMENSIONS ARE IN INCHES UNLESS OTHERWISE SPECIFIED.
 2. ALL DA,DB,LA,LB,WP,AL,AS AND J SERIES OF CAT.NO.S ARE LISTED BY "UNDERWRITERS INC." AND "CSA" FOR USE ON CODE WIRES AND FLEX/24 STRANDED CABLES.

PRE-FIX CAT.NO.WITH "L" HAS NOT PEEP HOLE UNLESS OTHERWISE SPECIFIED IN THE SUFFIX OF THE CAT.NO. WITH "P".

MATERIAL: HIGH CONDUCTIVITY WROUGHT COPPER

FINISH: ELECTOR-TIN PLATE UNLESS OTHERWISE SPECIFIED PER MIL - T -16366.
SUFFIX CAT.NO.WITH "SP" FOR SILVER.

INSTALLATION GUIDE

DIE CODE = __
DIE COLOR = __

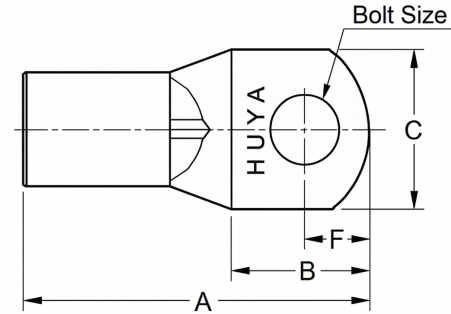

NEBS³



CE

HUYA[®]
www.huyaco.com

CELESTRA CORPORATION

76. Huancun Rd. Zhongcun Town.
Panyu Dist. Guangzhou 511495.

TITLE WIRE CONNECTORS AND SOLDERING
LUGS FOR CODE AND FLEX CABLE

| | | | |
|----------|------------------------|--------------|------------------------|
| MATERIAL | PRT. NO. J06AN0614 | SCALE NTS | THIRD ANGLE PROJECTION |
| FINISH | DWG. NO. 186-cp5340 | UNIT INCH | |

| | | | | | |
|-----|-----------|-----------|-----------|-------------------------------------|-----|
| 00 | 04-Apr-26 | Ruby Feng | Sinia Qiu | Celestra Standards Spec. Initialed. | |
| REV | DATE | DWN | CHK | DESCRIPTION | ECN |

4

3

2

1