

THE INFORMATION ON THIS DRAWING IS THE PROPERTY OF CELESTRA, IS DISCLOSED IN CONFIDENCE AND NOT TO BE REPRODUCED, USED OR DISCLOSED EXCEPT FOR WHICH FURNISHED.

| CELESTRA CAT.NO | Wire Size (mm ²) | Dimension (mm) | | | | |
|--------------------|------------------------------|----------------|-------|-------|-------|-------|
| | | Bolt Size | B | C | R | ID |
| MC2412F-40 | 240.00 | M12 | 43.50 | 39.00 | 51.30 | 21.00 |

NOTE:
 ALL DIMENSIONS ARE IN MILLIMETER UNLESS OTHERWISE SPECIFIED.
 MATERIAL: HIGH CONDUCTIVITY WROUGHT COPPER
 FINISH: ELECTRO-TIN PLATE

INSTALLATION GUIDE
 DIE CODE = 48
 DIE COLOR = --

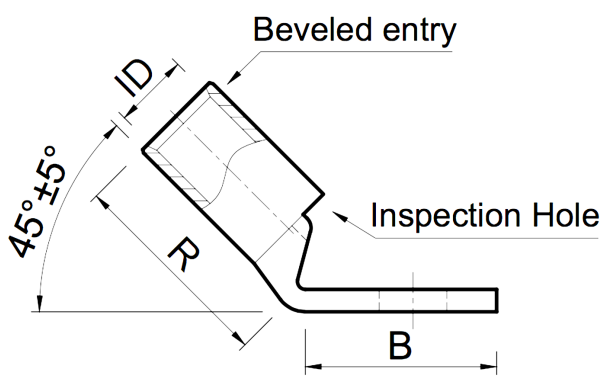

HUYA®
 www.huyaco.com

CELESTRA CORPORATION
 76. Huancun Rd. Zhongcun Town.
 Panyu Dist. Guangzhou 511495.

| | | | | | | |
|----------|----------------------------------|----------|------------|--|------|------------------------|
| TITLE | | | | WIRE CONNECTORS AND SOLDERING LUGS FOR CODE AND FLEX CABLE | | |
| MATERIAL | HIGH-CONDUCTIVITY WROUGHT COPPER | PRT. NO. | MC2412F-40 | SCALE | NTS | THIRD ANGLE PROJECTION |
| FINISH | ELECTRO TIN PLATE | DWG. NO. | 186-cp6164 | UNIT | INCH | |

| 00 | 20-Apr-26 | Ruby Feng | Sinia Qiu | Celestra Standards Spec. Initialed. | |
|-----|-----------|-----------|-----------|-------------------------------------|-----|
| REV | DATE | DWN | CHK | DESCRIPTION | ECN |