

4

3

2

1

THE INFORMATION ON THIS DRAWING IS THE PROPERTY OF CELESTRA, IS DISCLOSED IN CONFIDENCE AND NOT TO BE REPRODUCED, USED OR DISCLOSED EXCEPT FOR WHICH FURNISHED.

CELESTRA  
CAT.NO

Wire Size (mm<sup>2</sup>)

Dimension (mm)

MCX511645-252

500.00

Bolt Size

A

B

C

G

R

ID

M16 195.50 98.50 57.50 44.50 76.20 31.00

NOTE:

ALL DIMENSIONS ARE IN MILLIMETER UNLESS OTHERWISE SPECIFIED.

MATERIAL: HIGH CONDUCTIVITY WROUGHT COPPER

FINISH: ELECTRO-TIN PLATE

INSTALLATION GUIDE

DIE CODE = 100

DIE COLOR = --

Bolt Size

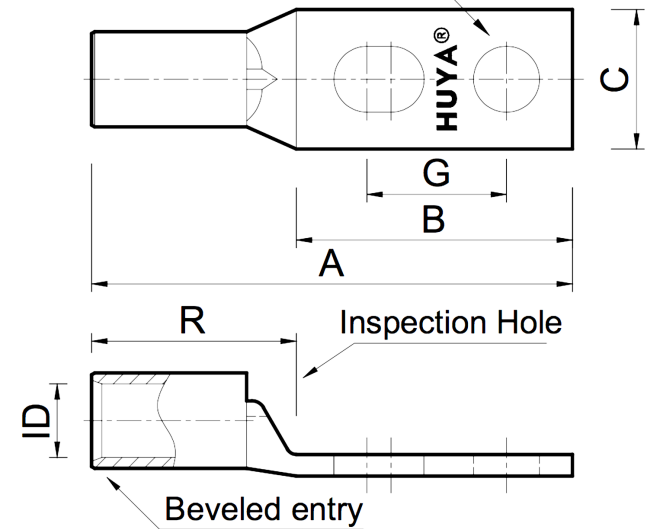

NEBS<sup>3</sup>



CE

**HUYA**<sup>®</sup>  
www.huyaco.com

**CELESTRA CORPORATION**

76. Huancun Rd. Zhongcun Town.  
Panyu Dist. Guangzhou 511495.

TITLE WIRE CONNECTORS AND SOLDERING  
LUGS FOR CODE AND FLEX CABLE

MATERIAL HIGH-CONDUCTIVITY  
WROUGHT COPPER

PRT. NO.  
MCX511645-252

SCALE  
NTS

THIRD ANGLE PROJECTION

FINISH  
ELECTRO TIN PLATE

DWG. NO.  
186-cp6455

UNIT  
INCH

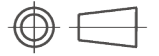

|    |           |           |           |                                     |  |
|----|-----------|-----------|-----------|-------------------------------------|--|
| 00 | 20-Apr-26 | Ruby Feng | Sinia Qiu | Celestra Standards Spec. Initialed. |  |
|----|-----------|-----------|-----------|-------------------------------------|--|

| REV | DATE | DWN | CHK | DESCRIPTION | ECN |
|-----|------|-----|-----|-------------|-----|
|-----|------|-----|-----|-------------|-----|

4

3

2

1